



## FINISHING AND PACKAGING

We take pride in what we do and what we deliver to your construction site. Every order is handled with care and completed to your exact specifications. For prefinishing, our trained personnel use automated, state-of-the-art equipment. This ensures that your doors will maintain their beautiful appearance for years to come. When your order is fulfilled, each door is securely packaged and accurately marked for on-time delivery. Please note that all Waudena™ doors are loaded onto steel racks that can be easily loaded and unloaded with a forklift.



*Our automated equipment provides a consistent coat of paint or stain, ensuring an ultra smooth finish.*



*All doors are securely packaged and protected until they reach your job site.*

### INTERIOR DOOR PAINT AND STAIN OPTIONS

#### PAINT COLORS



#### STAIN FINISHES

Amber | Cognac | Cider | Coffee | Light Oak | Nutmeg | Provincial | Rosewood | Winter Wheat | Pearl

Colors shown are approximate. Accurate paint and stain samples are available upon request.

**Building Our Reputation One Door at a Time**

Toll Free 877/933-0334 • Local 715/359-2524 • Fax 715/359-4717

[www.wausadoors.com](http://www.wausadoors.com)

WSTNT0206

Trim-N-Time® Installation System



**WAUDENA™ INTERIOR DOORS**  
Exclusive Installation System

MANUFACTURED BY



Building Our Reputation One Door at a Time





# WAUDENA™ INTERIOR DOORS Trim-N-Time® System INSTALLATION INSTRUCTIONS

## What is the Trim-N-Time® System?

Trim-N-Time® is a revolutionary system where the trim is pre-attached to the door. Based on extensive testing, we've found that Trim-N-Time® will reduce your installation time by over fifty percent. Material waste is also eliminated. No more overages or shortages of trim to worry about.

Wausau Supply Company is the only manufacturer to offer this all-in-one system. Our doors are pre-mitered, pre-machined, pre-assembled and pre-finished. If you want to save time and have perfect miters, our innovative Trim-N-Time® system is for you.

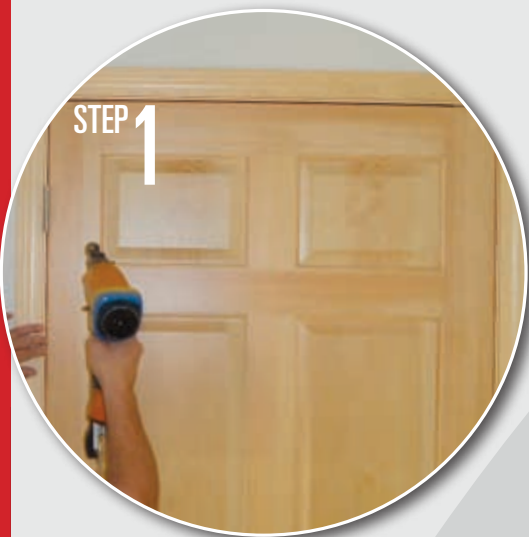

STEP 1

### Step 1: Center Door in Opening

Remove packaging materials and unscrew the shipping plug. Center the door in the opening, making sure that the outside perimeters match up to one another. We recommend a rough opening height of 82-1/2" to allow for floor coverings.



STEP 2

### Step 2: Shim

Use wooden shims to help center and hold the unit in the opening. Be sure to completely fill the gap between the door frame and stud framing where the hinges and lock set will attach.



STEP 3

### Step 3: Fasten Hinge Side

Once the door is perfectly level, fasten the hinge side by running the top screw in first. This will alleviate the weight of the door. It is advised to work from top to bottom when installing the hinge side.



STEP 4

### Step 4: Fasten Latch Side

After fastening the hinge side, fasten the latch side. Test the door swing by opening and closing the unit enough to confirm that the space available between the door and jamb is correct.



STEP 5

### Step 5: Insert Casing Side

The final step requires the casing side to be inserted into the dadoed jamb. The adjustable casing side with the 5/8" lip will accommodate a varying wall thickness from top to bottom. A 4-9/16" jamb can be used for wall depths up to 5". After the casing lip is inserted, secure with finishing nails.



### Trim-N-Time® Passage Door Specifications:

**Species:** See below

**Depth:** 4-9/16" or 6-9/16"

**Height:** Up to 8'

**Widths:** Any Casing Width

**Casing Option:** Any casing must be 9/16 or thicker

*Please Note: On passage and bi-pass doors 2/0 or less, miters are not glued on adjustable side.*



### Bifold Doors (2/0 or above)

*Please Note: Miters are not glued on the casing side facing the inside of the closet.*



### Jamb Extensions Available for Vinyl Windows

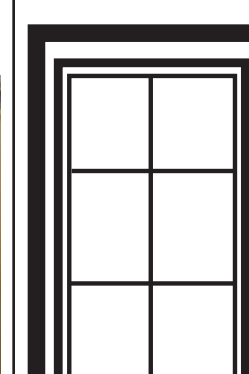

### Trim-N-Time® Window Specifications:

**Species:** See above

**Casing Option:** Any casing must be 9/16 or thicker

**Depth:** 1-1/2" up to 7"

**Size:** Up to 96 x 96 inches

Special casing lip inserts into dadoed side jamb

Back View